

BTL 1000

HORIZONTAL COOLERS



new
2020

DETAILS

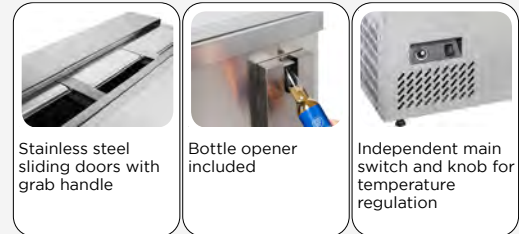

Stainless steel sliding doors with grab handle

Bottle opener included

Independent main switch and knob for temperature regulation

GENERAL FEATURES

- Horizontal cooler with N.2 sliding door
- Stainless Steel exterior and interior
- Static Cooling
- Manual Defrost
- Rear and lateral side airflow panel holes
- Foaming Agent Cyclopentane (45mm per side)
- Mechanical thermostat
- Easy removable top
- Stainless steel sliding doors with grab handle
- Bottle opener included
- Independent main switch
- N.4 Adjustable feet
- Energy efficiency class: -

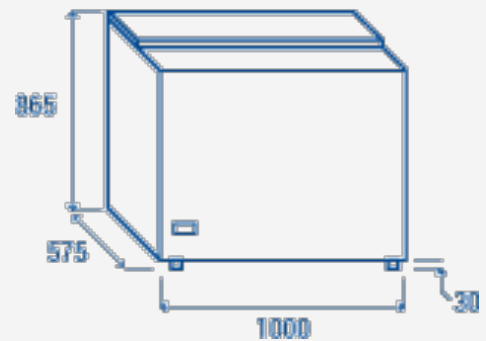

PRODUCT DIMENSIONS

TECHNICAL SPECIFICATIONS

Capacity	248 L
Temperature	+0° - +8°C
Consumption	1.5 kWh/24h
Rated Power	200 W
Noise level	52 dB(A)
Net Weight	55 Kg
Gross Weight	67.5 Kg
External Dimensions (WxDxH mm)	1000x575x865
Internal Dimensions (WxDxH mm)	895x470x765
Packaging dimensions (WxDxH mm)	1040x610x1015
Loading quantities 20'/40'/40"HQ	40/76/76

CERTIFICATION

CE RoHS



www.hosdecora.com Tel: 976 255 991

